

► Product Features

- Extremely long life (2M, 5M)
- Precision linearity ($\pm 1\%$, $\pm 2\%$)
- IP65 waterproof
- Wide temperature range
- 2W power rating
- Custom shaft, bushing, or output curve



► Specification

Rotational life cycles	2,000,000 (standard) ; 5,000,000 (special)
Independent linearity	$\pm 1\%$, $\pm 2\%$, $\pm 3\%$
Water resistance	IP65
Power rating	2 watt at 40°C
Operating temperature	-40°C ~105°C
Mechanical angle	360°, 312°, 300°
Electrical angle	70°~340°

► Part Number

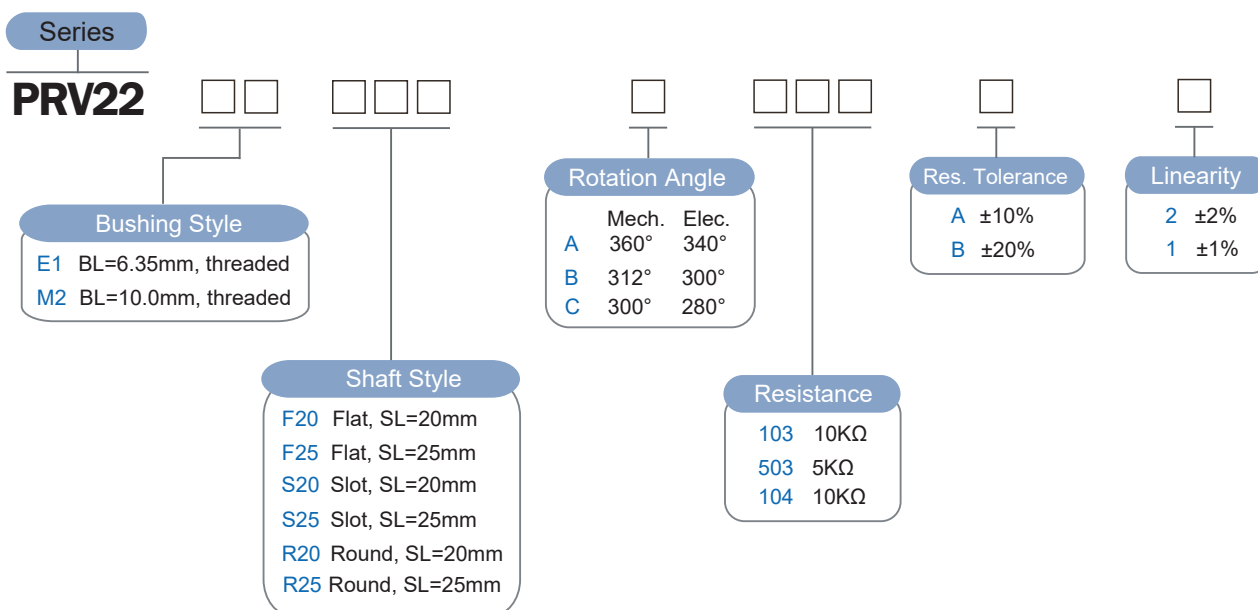

Potentiometer

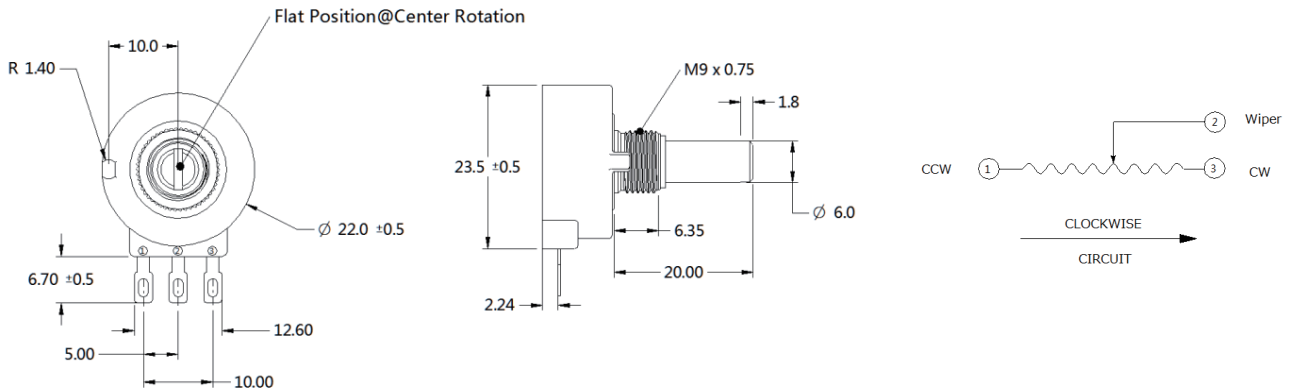

Shaft Style

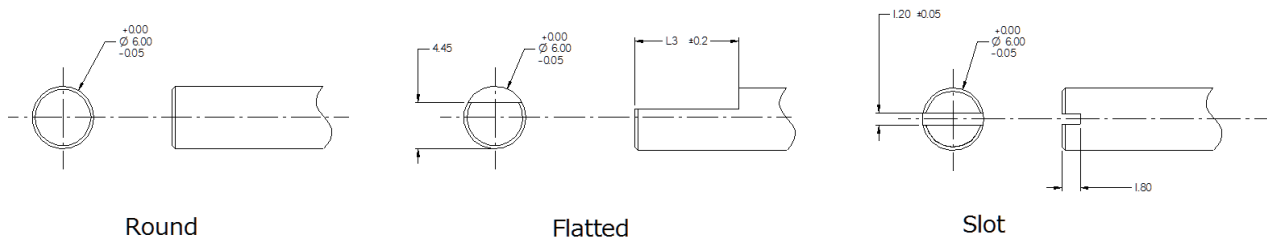

Note: For flatted shaft, L3 should be defined as "FMS=20mm, L3=8.7mm, FMS=25, L3=13mm"