

### ► Product Features

- Dual output for drive-by-wire application
- Precision  $\pm 1\%$ ,  $\pm 2\%$  linearity
- 2 million life cycles min.
- IP68, IP69K water resistance
- EMI free via automotive inductive technology
- Demand sensing of vehicle acceleration



### ► Materials

Part Description	Housing	Housing Insert	Cover	Rotor	Target	Seal
Material	PBT with GF	Brass	PBT with GF	Nylon66 with GF	Stainless Steel	NBR

### ► Specification

Rotational life cycles	2 million cycles min.
Independent linearity	$\pm 1\%$ , $\pm 2\%$
Water resistance	IP68, IP69K
Electrical output	Single, Dual
Rated voltage	5V
Total rotational angle	120°
Electrical angle	40°~110°

### ► Part Number

Series						
<b>DTP8</b>	<input type="checkbox"/>	<input type="checkbox"/>	<input type="checkbox"/> <input type="checkbox"/> <input type="checkbox"/>	<input type="checkbox"/> <input type="checkbox"/> <input type="checkbox"/>	<input type="checkbox"/>	<input type="checkbox"/>
	Electrical	Linearity	Rotation	Elect. Angle	Curve Type	Wire harness
	D Dual Output S Single Output	2 $\pm 2\%$ 1 $\pm 1\%$	CW CW CCW CCW	68 68° 105 105° Custom available	C Cross D Diverge	150 150mm length Custom available

# DTP8D

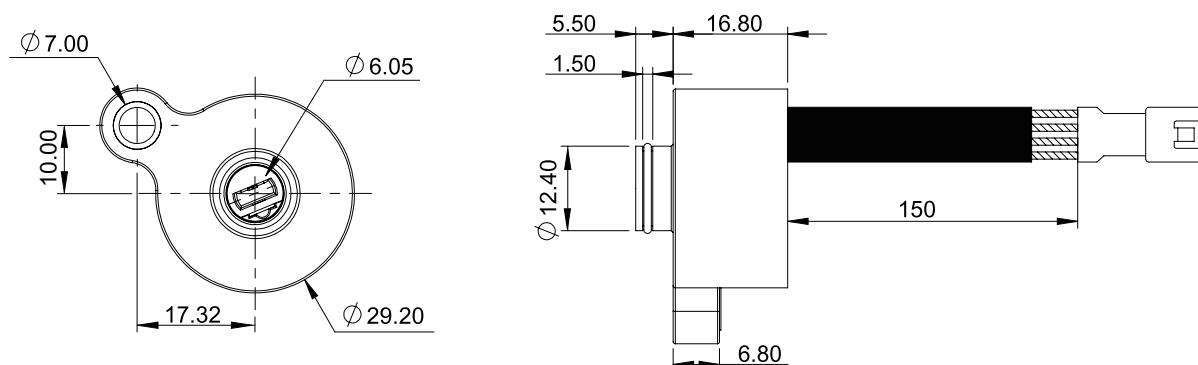

### Mounting Requirement

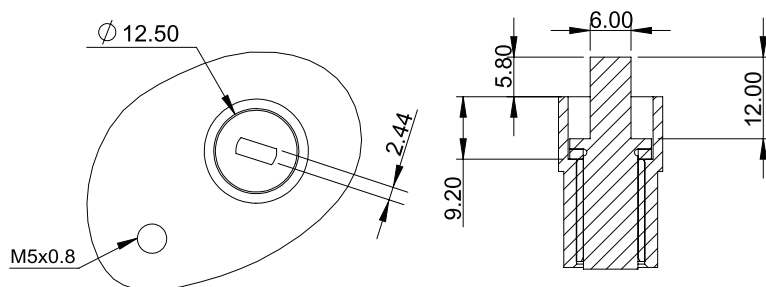

### Pin Definition

PIN	Description
1	GND
2	Vout 1
3	+5V
4	GND
5	Vout 2
6	+5V

## Output Curve

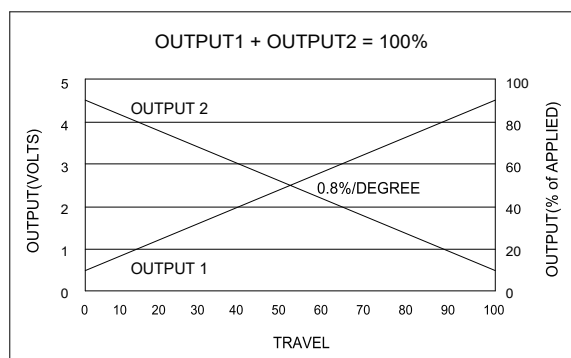

### Cross type

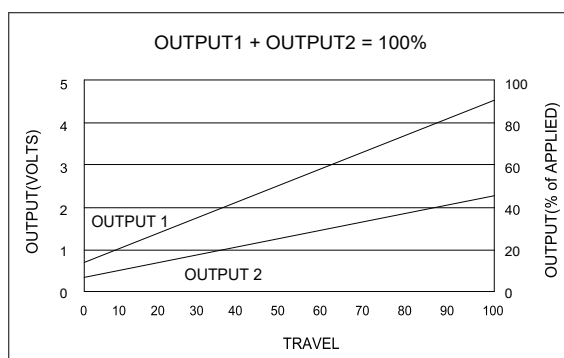

Divergence type